

---

# Comfort-Aire®

---

PARTS LIST

## Portable Air Conditioner PS-81G



# EXPLODED VIEW

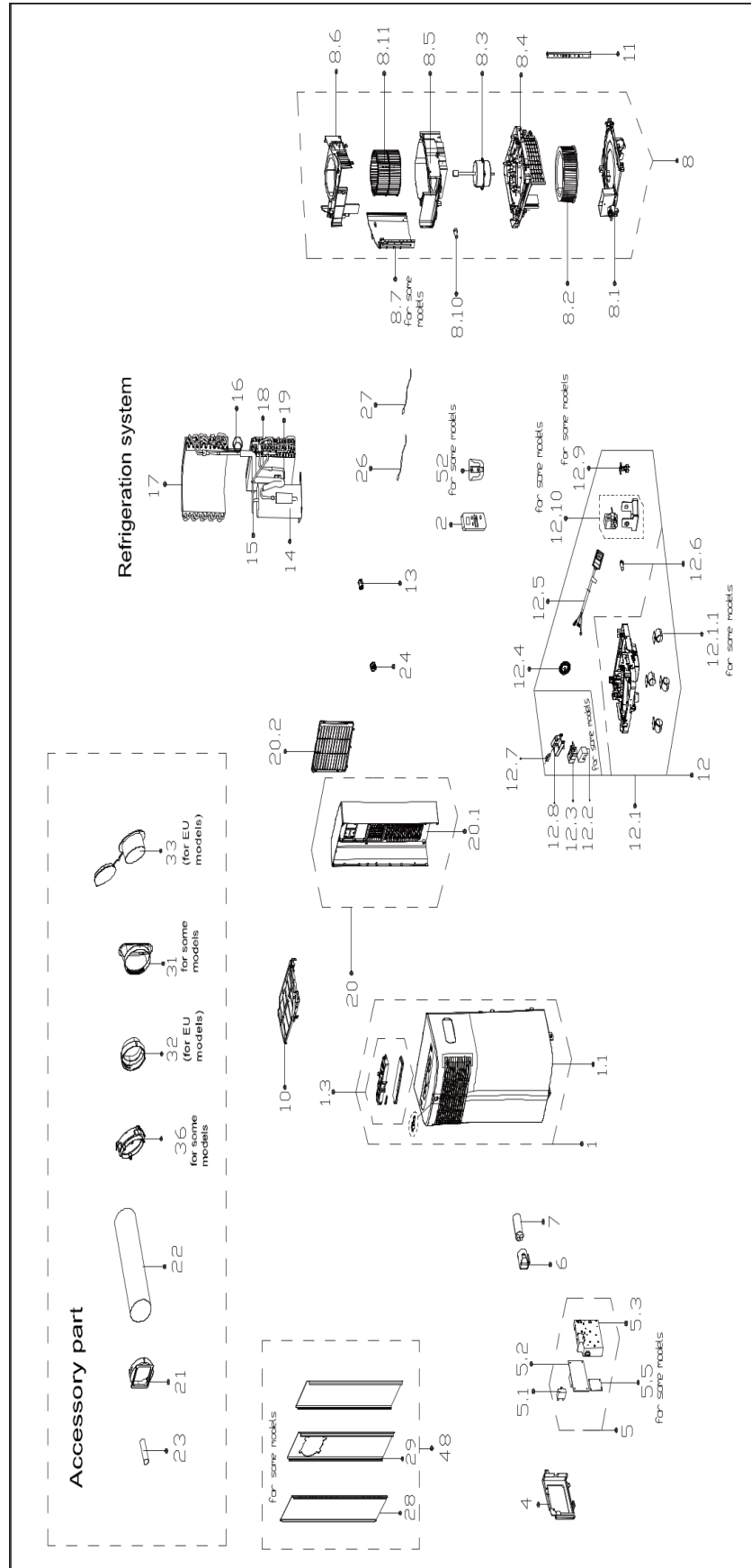

## REPLACEMENT PARTS

Location	Part Name	Quantity	Part No.
1	Front panel assembly	1	12120600A31710
1.1	Front panel subassembly	1	12120600A31672
1.3	Display board subassembly	1	17220600A07131
2	Remote controller	1	17317000A57281
5	Electronic control box subassembly	1	17220600002563
5.1	Fan motor capacitor	1	17400101000699
5.2	Main control board subassembly	1	17120600002892
5.3	Electronic control box subassembly	1	12120600006212
6	Capacitor box	1	12100601000106
7	Capacitor of compressor	1	17400103000052
8	Air outlet volute shell assembly	1	12120600006284
8.1	Air exhaust volute shell subassembly	1	12120600006208
8.2	centrifuge fan	1	12100103001124
8.3	Single phase asynchronous motor	1	11002012032735
8.4	Cover subassembly of air exhaust volute shell	1	12120600006209
8.5	air volute subassembly	1	12120600006725
8.6	Cover for Air outlet volute shell	1	12120600006207
8.10	Drain Stopper	1	12600801000048
8.11	centrifuge fan	1	12100103001125
9	Front panel assembly	1	12120600A31710
10	internal air duct Assemble	1	12120600006323
11	Supporting bar	2	12220600000642
12	Chassis assembly	1	12120600007423
12.1	Chassis subassembly	1	12120600007666
12.1.1	Universal wheel	4	12620100000015
12.4	Water wheel	1	12120600006923
12.5	Power cord subassembly of LCDI	1	17401202006867
12.9	Water Level Switch	1	17400511000164
12.10	Shaded-pole Motor	1	11002017002726
14	Fixed Speed Rotary Compressor	1	11103010017415
15	Discharge pipe assembly	1	15120600003111
16	Capillary assembly	1	15120600003657
17	Evaporator assembly	1	15820600001457
18	Condenser assembly	1	15820600001177
19	Suction pipe assembly	1	15120600003137
20	Rear Panel assembly	1	12120600A25661
21	Connector, air exhaust duct	1	12120600006211
22	Exhaust hose subassembly	1	12120600A12675
23	Drain Hose	1	12100509000040
24	Drain connection	1	12122000026164
26	Pipe Temperature Sensor	1	11201007003439
27	Room Temperature Sensor	1	11201007003448
28	Window Sealing Board	1	12120600004203
29	Window Sealing Board	1	12120600004204

Due to ongoing product improvements, specifications and dimensions are subject to change and correction without notice or incurring obligations. Determining the application and suitability for use of any product is the responsibility of the installer. Additionally, the installer is responsible for verifying dimensional data on the actual product prior to beginning any installation preparations.

Incentive and rebate programs have precise requirements as to product performance and certification. All products meet applicable regulations in effect on date of manufacture; however, certifications are not necessarily granted for the life of a product. Therefore, it is the responsibility of the applicant to determine whether a specific model qualifies for these incentive/rebate programs.

*Comfort-Cure*®

1900 Wellworth Ave., Jackson, MI 49203 • Ph. 517-787-2100 • [www.marsdelivers.com](http://www.marsdelivers.com)

